

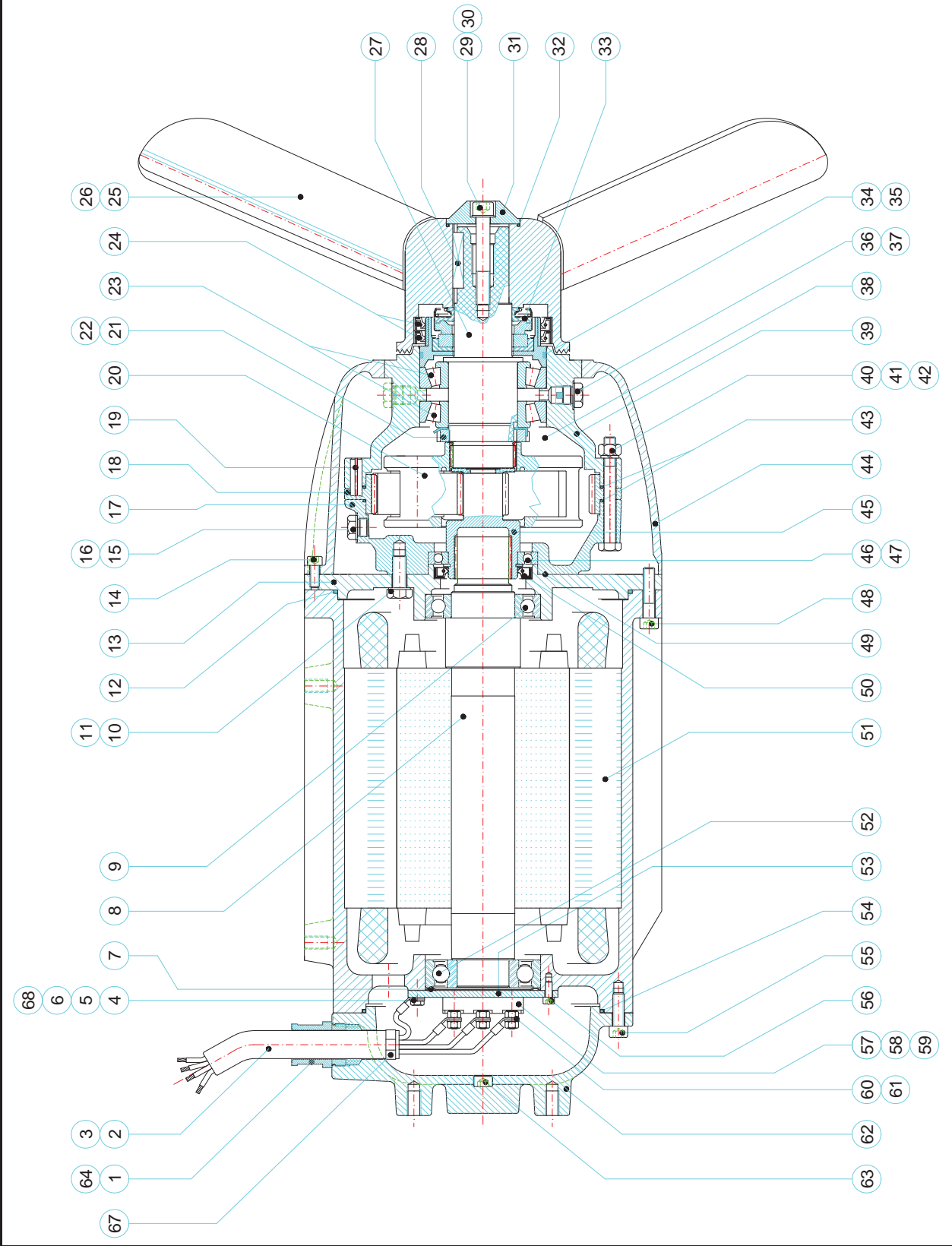

Spare Parts List			
TBM Submersible Horizontal Mixer Series			
Version			
11/4	15/4N	18.5/4N	
Bill of Materials No.			
2.00170	2.00831	2.00832	





Spare Parts List

TBM Submersible Horizontal Mixer Series

Version

11/4 15/4N 18.5/4N

Bill of Materials No.

2.00170 2.00831 2.00832

Pos.	Code	Description	Necessary Q.ty of Spare Parts		
1	0.02639	Cable gland	1	1	1
2	1.01598	Cable	10	10	10
3	1.00337	Eyelet terminal	7	7	7
4	1.00190	Screw	1	1	1
5	1.00460	Washer	1	1	1
6	1.02225	Terminal strip	1	1	1
7	1.00280	Ring	1	1	1
8	0.00664	Shaft with rotor 11 kW	1		
8	0.00665	Shaft with rotor 15 kW		1	
8	0.00666	Shaft with rotor e 18.5 kW			1
9	1.00212	Bearing	1	1	1
10	1.00145	Screw	6	6	6
11	1.00503	Washer	6	6	6
12	1.00313	OR ring	1	1	1
13	0.00645	Bearing housing	1	1	1
14	1.00109	Screw	2	2	2
15	1.00592	Plug	3	3	3
16	1.00470	Washer	3	3	3
17	0.00297	Flange	1	1	1
18	0.01113	Crown gear	1	1	1
19	1.00631	Pin	4	4	4
20	0.01112	Reduction	1	1	1
21	1.00450	Ring nut	1	1	1
22	1.00514	Washer	1	1	1
23	1.00200	Bearing	2	2	2
24	1.02125	Lip seal	2	2	2
25	0.00672	Propeller 11 kW	1		
25	0.00671	Propeller 15 kW		1	
25	0.00670	Propeller 18.5 kW			1
26	1.00390	Screw	2	2	2
27	0.00301	Propeller shaft	1	1	1
28	1.00548	Key	1	1	1
29	1.00100	Screw	1	1	1
30	1.00461	Washer	1	1	1
31	0.00304	Washer	1	1	1
32	1.00301	OR ring	1	1	1
33	1.00522	Mechanical seal	1	1	1
34	0.00323	Bushing	1	1	1
34	0.04016	Chrome plated bush	1	1	1
35	1.00302	OR ring	1	1	1
36	1.00592	Plug	3	3	3
37	1.00470	Washer	3	3	3
38	1.00667	Oil	1.2	1.2	1.2
39	0.00298	Casing	1	1	1
40	1.00150	Screw	8	8	8
41	1.00405	Nut	8	8	8
42	1.00469	Washer	8	8	8
43	1.00306	OR ring	2	2	2
44	0.00651	Cover	1	1	1



Spare Parts List

TBM Submersible Horizontal Mixer Series

Version

11/4 15/4N 18.5/4N

Bill of Materials No.

2.00170 2.00831 2.00832

Pos.	Code	Description	Necessary Q.ty of Spare Parts		
45	0.03255	Pinion	1	1	1
46	1.00201	Bearing	1	1	1
47	1.00253	Snap ring	1	1	1
48	1.00135	Screw	6	6	6
49	0.01806	Gasket	1	1	1
50	1.00351	Lip seal	1	1	1
51	0.00653	Motor casing+Stator kW 11 - 4P	1		
51	0.00654	Motor casing+Stator kW 15 - 4P		1	
51	0.00655	Motor casing+Stator kW 18.5 - 4P			1
52	1.00211	Cuscinetto radiale rigido a sfere	1	1	1
53	0.00643	Terminal strip plate	1	1	1
54	1.00282	OR ring	1	1	1
55	1.00130	Screw	6	6	6
56	1.00120	Screw	4	4	4
57	1.00339	Terminal strip	1	1	1
58	1.00120	Screw	2	2	2
59	1.00462	Washer	2	2	2
60	1.00403	Nut	12	12	12
61	1.00465	Washer	12	12	12
62	0.02636	Head cover	1	1	1
63	1.00590	Plug	1	1	1
64	0.02638	Gasket	1	1	1
65	1.01810	Sheath	1	1	1
66	1.01811	Seal	1	1	1
67	1.01474	Cable ties	1	1	1
46	1.00326	Tipped terminal	2	2	2