

## 862003 - KKCM150LA+004061N1 EFFLUENT SUBMERSIBLE PUMP

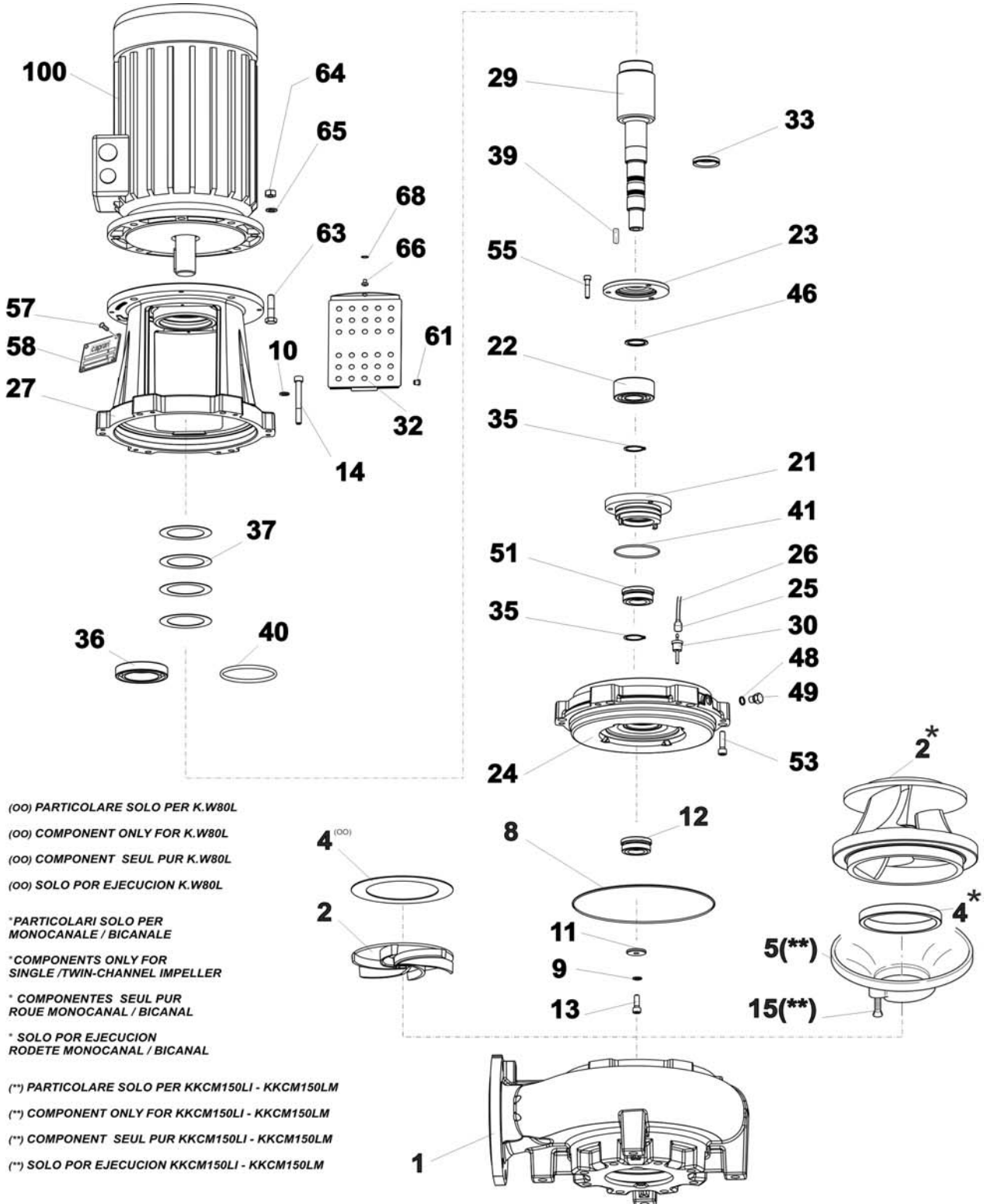

(OO) PARTICOLARE SOLO PER K.W80L

(OO) COMPONENT ONLY FOR K.W80L

(OO) COMPONENT SEUL PUR K.W80L

(OO) SOLO POR EJECUCION K.W80L

\*PARTICOLARI SOLO PER  
 MONOCANALE / BICANALE

\*COMPONENTS ONLY FOR  
 SINGLE /TWIN-CHANNEL IMPELLER

\*COMPONENTES SEUL PUR  
 ROUE MONOCANAL / BICANAL

\*SOLO POR EJECUCION  
 RODETE MONOCANAL / BICANAL

(\*\*) PARTICOLARE SOLO PER KKCM150LI - KKCM150LM

(\*\*) COMPONENT ONLY FOR KKCM150LI - KKCM150LM

(\*\*) COMPONENT SEUL PUR KKCM150LI - KKCM150LM

(\*\*) SOLO POR EJECUCION KKCM150LI - KKCM150LM

ATTENZIONE! DISEGNO VALIDO ANCHE PER KKD200N. + 004061N2 / + 005562N2

WARNING! DESIGN VALID FOR KKD200N. + 004061N2 / + 005562N2

ATTENTION! VALABLE POUR KKD200N. + 004061N2 / + 005562N2

¡ATENCIÓN! DISEÑO VÁLIDO PARA KKD200N. + 004061N2 / + 005562N2



## COMPONENTS LIST

Pos.	Code	Serial N°	Description	Qty
	1001208			1 PZ
1	500283	KM150L/C-1	DELIVERY CASING	1 PZ
2	470117	KMILNA-5	IMPELLER D.285	1 PZ
4	440501	KMIL-165	WEAR RING	1 PZ
8	330386	OR01932	OR SEAL 278,99X3,53 OR41100(AP)	1 PZ
9	300892	RE01913	SPRING WASHER A 10 UNI1751-A2	1 PZ
10	300892	RE01913	SPRING WASHER A 10 UNI1751-A2	6 PZ
11	310340	RLS02581	WASHER	1 PZ
12	330200	TFR02124	MECHANICAL SEAL BT-AR35-Q1VPPF	1 PZ
13	300241	VTT01936	SCREW M10X30 UNI 5931 A4-80	1 PZ
14	300245	VTT02121	SCREW M10X90 UNI5931-A2	6 PZ
	1001049			1 PZ
21	400535	KC090/EX-4	BEARING HOUSING	1 PZ
22	350113	CSN0943	BEARING 3307/C3	1 PZ
23	410646	KK3-9	BEARING COVER	1 PZ
24	420028	KC04041L/EX-22	OIL CHAMBER	1 PZ
26	350250	CV02459	ROUND CABLE N07V-K 1X2.5 L=1,25 METERS	1 M
27	420226	KK3-32	LANTERN BRACKET	1 PZ
29	520208	KK3/132-7	PUMP SHAFT	1 PZ
30	470922	KC018/E-270	PROBE	1 PZ
32	460290	KK3-240	PTO SHAFT GUARD	2 PZ
33	330249	AT02426	SEAL RING V 40 S (A+P)	1 PZ
35	310554	AE0350	CIRCLIP 35 UNI 7435 FOR SHAFT	2 PZ
36	350032	CSN02420	BEARING 6013-2RS1/C3	1 PZ
37	330516	MOL02418	SPRING ELL65 99X70,5X1	4 PZ
39	310435	LCH0933	FEATHER KEY A8X7X40 UNI6604-C50	1 PZ
40	330441	OR02425	OR SEAL 100X5.34 OR189 (AP)	1 PZ
41	330381	OR01915	OR SEAL 82,22X2,62 OR3325 (AP)	1 PZ
46	310349	RLS01788	WASHER 35X45X2,5 SEEGER TYPE SS	1 PZ
48	310270	RLS01907	WASHER 14X18X1,5	4 PZ
49	310694	TF01908	PLUG 1/4"GAS	2 PZ
51	330193	TFR01934	MECHANICAL SEAL BT-AR35-BXPFF	1 PZ
53	300243	VTT02063	SCREW M10X40 UNI5931-A2	6 PZ
55	300065	VTT01877	SCREW M8X40 UNI5931-A2	3 PZ
61	470931	KC055-271	PROBE HOLDER	1 PZ
63	300057	VTE02559	SCREW M12X45 UNI5737-A2	4 PZ
64	310203	DN01435	NUT M12 UNI5588-A2	4 PZ
65	300895	RE02101	SPRING WASHER A 12 UNI1751-A2	4 PZ
66	300070	VTT02453	SCREW M6X10 ISO 7380 A4-70	2 PZ
67	310509	FS02459	CLAMP 203X3,6 (PLT2I-M PANDUIT)	1 PZ
68	310254	RLS02560	WASHER 6,4X11X1,5 DIN F ANTI LOST	1 PZ
100	350669	KKC004061N132N1	ELECTRIC SUBMERGIBLE MOTOR	1 PZ

